

Jade Screen Series

Create a more Valuable Urban Advertising Media

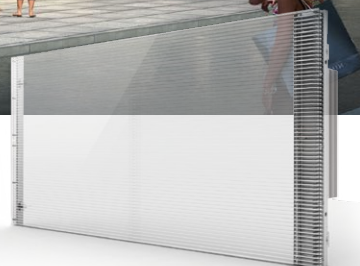

Very see-through, without any change of architectural appearance and transparency of glass wall, create the open view in large space indoors, and make advertising emerge into architecture and life.



Key Features

82% Transparency

Very see-through, without any change of architectural appearance and transparency of glass wall, make ad emerge into building and life.



Smart control

Smart control by mobile APP, wireless data transmission, screen+ data cloud + APP, WIFI connection.



Wider advertising Scope | viewing angle 120°

YIPLD Jade Screen delivers awe-inspiring picture quality across the entire screen, even from wide viewing angles.



Modularized | DIY design

Any size screen combination flexible, no steel structure, no complicated installation, easy and convenient.

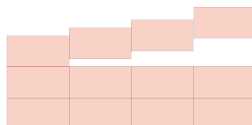

High brightness | 5500cd / m²

still visible clearly under strong light.



Jade Screen Series

Create a more Valuable Urban Advertising Media

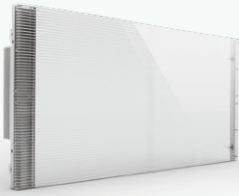

Screen Size

1000 × 500, 500 × 500

Application Scenarios

Glass wall, large indoor space

Jade Screen Series

- Transparency: 82%
- Brightness : 5500cd/m²
- Depth: 21mm
- Viewing Angle: 120°



Modularized



120° Wide Viewing Angle



Simple Colorful



New Configuration

Other Features

Super(or ultra) transparent

More than 82% transparency, the highest transparency in led screen industry.

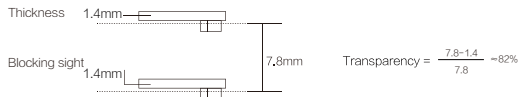

High contrast ratio

High contrast ratio 1500:1, stunning color, dynamic image and eye-catching.



Smart

Smart control by mobile APP, wireless data transmission, screen+data cloud+APP, WIFI connection.



High refresh rate

High refresh rate: in the industry, the minimum pixel pitch (able to mass production) 3mm, 3840HZ refresh rate.



Simple

No complicated installation, No steel structure, fast positioning and fast installation, convenient and quick maintenance.



New Configuration

The shape innovation of static glass, new screen displaying, new advertising type.



Dimensions (unit : mm)

1000 × 500 × 73 /
7 Kg

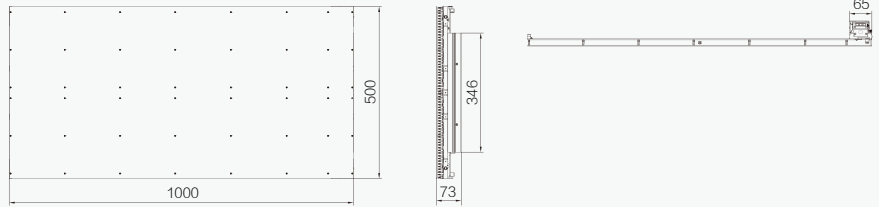

500 × 500 × 73 /
4.25 Kg

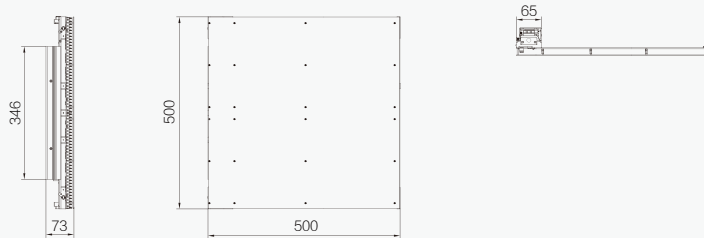

Connectivity

- ① Live wire
- ② Neutral wire
- ③ Earth wire
- ④ LAN

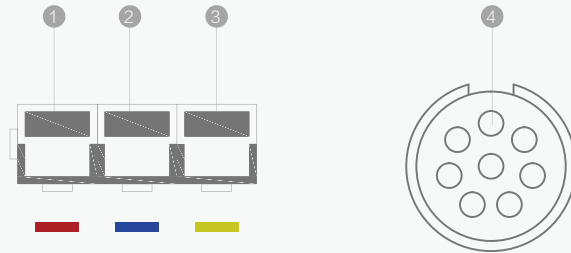

2 Types of Installation

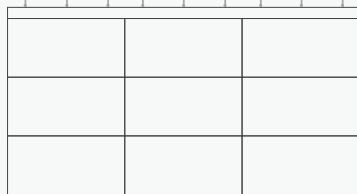

Hang

Floor stand

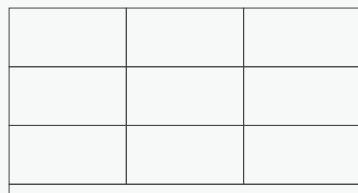

Specifications

Size (mm)	1000X 500		500X 500	1000X 500		500X 500
Model	J3			J10		
	-R1000	-L1000	-L500	-R1000	-L500	-L500
Pixel Pitch (mm)	3.9 x 7.8			10.4 x 10.4		
Pixel Density (dot/m ²)	32768			9216		
Module Resolution (dot)	256 X 64		128 X 64	96 X 48		48 X 48
LED Type	SMD 3 in 1			SMD 3 in 1		
Brightness (cd/m ²)	5500			5000		
Transparency	82%			87%		
Viewing Angle	120			120		
Grey Level	14bits			14bits		
Scan Mode	1/4			1/2		
Refresh Rate (Hz)	3840			3840		
Frame Frequency (Hz)	60			60		
Avg.Power Consumption(W/ m ²)	240			300		
Max.Power Consumption(W/ m ²)	800			800		
Maintenance	Back			Back		
IP	IP42			IP42		
Working Temp	-20~50°C			-20~50°C		
Weight (kg/ m ²)	14		17	13		16

System topology

